

00131211

Components:

00131078 "Bolted & Gasketed"

# Assembly

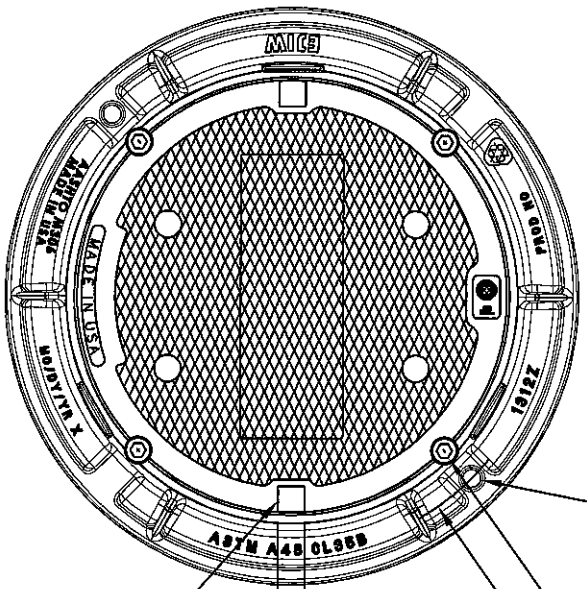

(2) 1" HANDLING HOLES

(4) 1/2-13 SS HEX HEAD BOLTS W/WASHERS

28 1/2" DIA. BOLT CIRCLE

1 1/2"

(2) CLOSED PICKHOLES

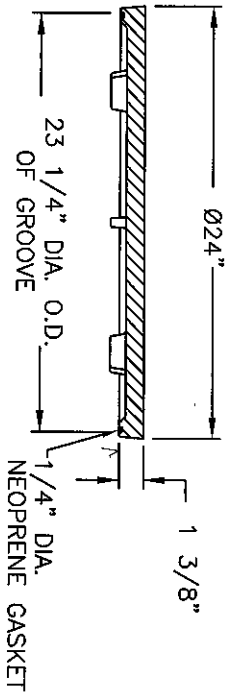

COVER SECTION

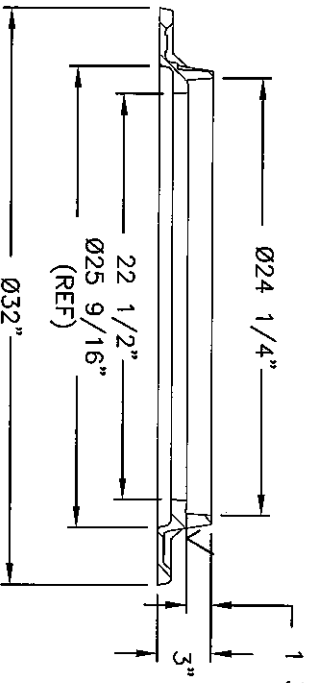

FRAME SECTION

- Design Features**
- Materials
  - Cover: Gray Iron (CL35B)
  - Frame: Gray Iron (CL35B)

- Design Load: Heavy Duty
- Open Area: n/a
- Coating: Undipped
- V-Designates Machined Surface

- Certification**
- ASTM A48
  - Country of Origin: USA

Lakelands Product #1007

**Drawing Revision**  
 08/12/2013 Designer: DAE  
 Revised By:

**Disclaimer**  
 Weights (lbs/kg), dimensions (inches/mm) and drawings provided for your guidance. We reserve the right to modify specifications without prior notice.

**CONFIDENTIAL:** This drawing is the property of EJ GROUP, Inc., and embodies confidential information, registered marks, patents, trade secret information, and/or know how that is the property of EJ GROUP, Inc. Copyright © 2012 EJ GROUP, Inc. All rights reserved.

**Contact**  
 800 626 4653  
 ejco.com