



Lakelands Concrete Products, Inc.  
7520 East Main St., Lima, NY 14485  
Phone: 585-624-1990, Fax: 585-624-2102

Web: [www.lakelandsconcrete.com](http://www.lakelandsconcrete.com)  
E-mail: [sales@lakelandsconcrete.com](mailto:sales@lakelandsconcrete.com)

Date: 7/11/11

DWG: PB213018

Pullbox  
21"x30"x18"

PB213018

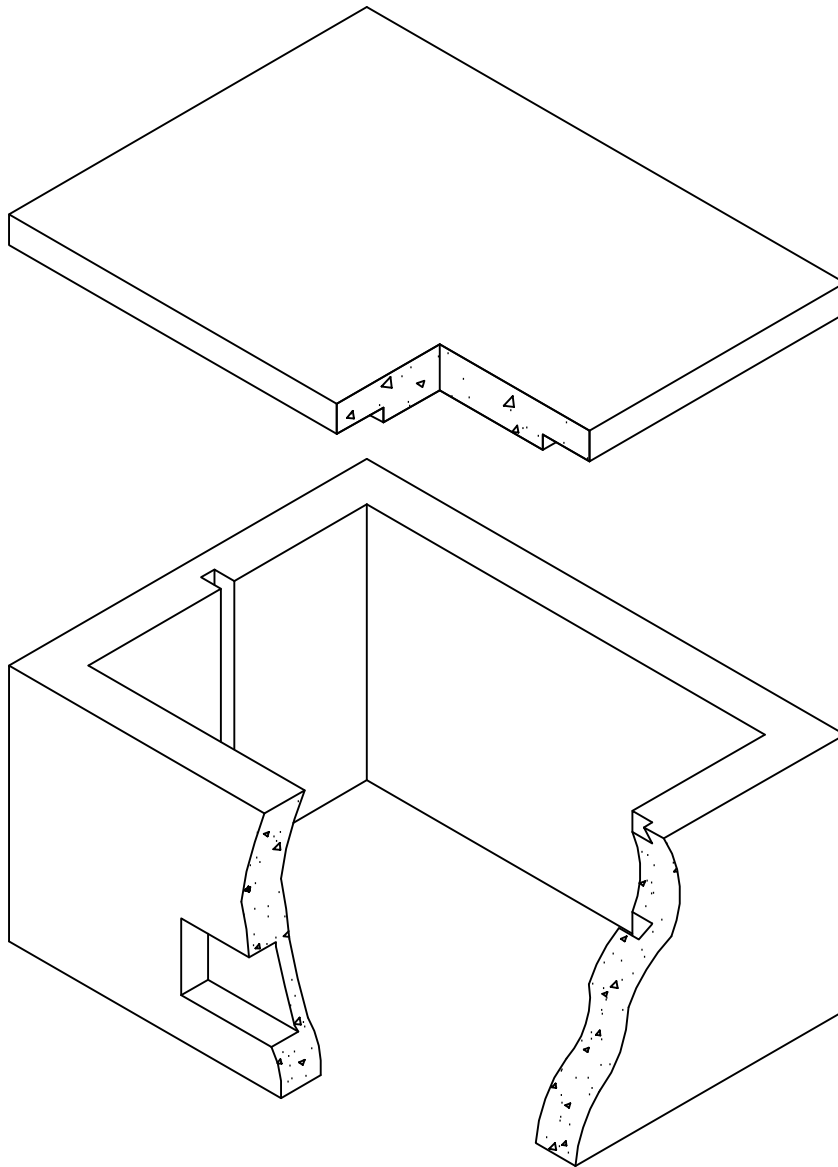



Lakelands Concrete Products, Inc.  
 7520 East Main St., Lima, NY 14485  
 Phone: 585-624-1990, Fax: 585-624-2102

Web: www.lakelandsconcrete.com  
 E-mail: sales@lakelandsconcrete.com

Date: 7/11/11

DWG: PB213018

Pullbox  
 21"x30"x18"

PB213018

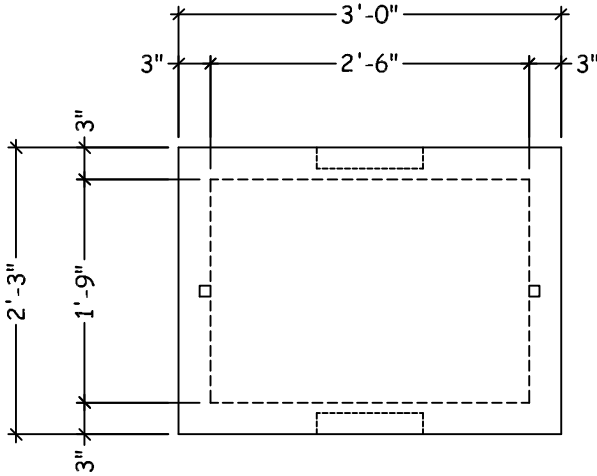

PLAN VIEW

- Specifications:
- Design Criteria: 5000 Psi @28 Days
  - Entrained Air: 5% - 9%
  - Design Loading: 300 PSF
  - Reinforcement: BAR-ASTM A615 GR60  
 WWR-ASTM A185/A497 GR65

Notes:

- \*Concrete Cover Available With Various Size Openings
- \*Various Size Knockouts Or Openings As Required
- \*Cast Iron Frame And Covers Available

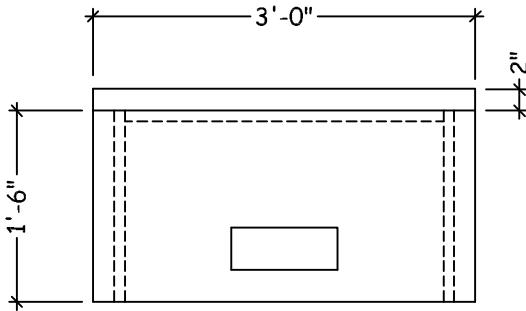

ELEVATION VIEW

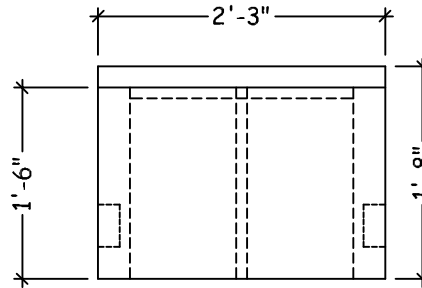

ELEVATION VIEW

Weights:  
 Box: 535 LBS  
 Cover: 253 LBS